

HSF

Recommended P.C.B Layout(Top Side)
(PCB BOARD TOLERANCE±0.05)

NOTES:
Current Rating:7.0AMP
Contact Resistance: 20mΩ Max
Withstand Voltage: 1500V AC/DC
Insulation Resistance: 1000MΩ Min
Operation Temperature: -40℃ to +105℃

Contact Material:Brass \triangle
Contact plating: Au Or Sn over Ni
Insulator Material:PA66 UL94V-2(STD)
or 94-V0 \triangle

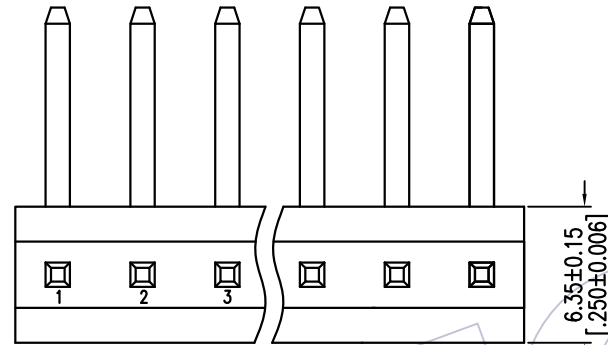
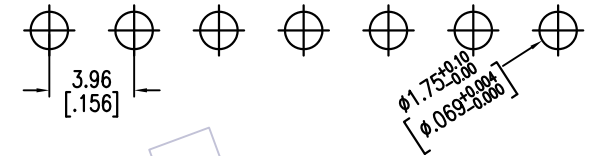

Dimensional & Ordering Information:

Circuit	Part No.	Dimension	
		A	B
02	WF3962-WR02WOX	3.96	7.92
03	WF3962-WR03WOX	7.92	11.88
04	WF3962-WR04WOX	11.88	15.84
05	WF3962-WR05WOX	15.84	19.80
06	WF3962-WR06WOX	19.80	23.76
07	WF3962-WR07WOX	23.76	27.72
08	WF3962-WR08WOX	27.72	31.68
09	WF3962-WR09WOX	31.68	35.64
10	WF3962-WR10WOX	35.64	39.60
11	WF3962-WS11WOX	39.60	43.56
12	WF3962-WR12WOX	43.56	47.52
13	WF3962-WR13WOX	47.52	51.48
14	WF3962-WR14WOX	51.48	55.44
15	WF3962-WR15WOX	55.44	59.40
16	WF3962-WR16WOX	59.40	63.36
17	WF3962-WR17WOX	63.36	67.32
18	WF3962-WR18WOX	67.32	71.28
19	WF3962-WR19WOX	71.28	75.24
20	WF3962-WR20WOX	75.24	79.20
21	WF3962-WR21WOX	79.20	83.16
22	WF3962-WR22WOX	83.16	87.12
23	WF3962-WR23WOX	87.12	91.08
24	WF3962-WR24WOX	91.08	95.04

Ordering Information

WF3962 -WR XX W 0 X

No. of pins: 02~24P
Contact Plating: G0=Gold Flash, G3=10u"Gold, G4=15u"Gold, G5=30u"Gold, Blank=Tin
Color: W=White
Packing: 0=PE Bag

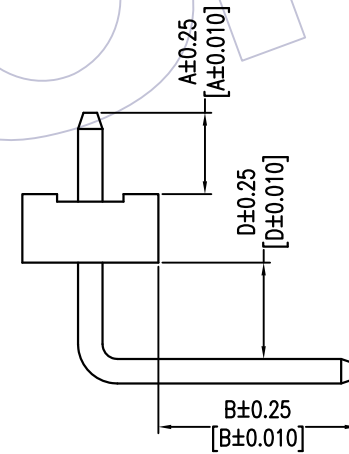
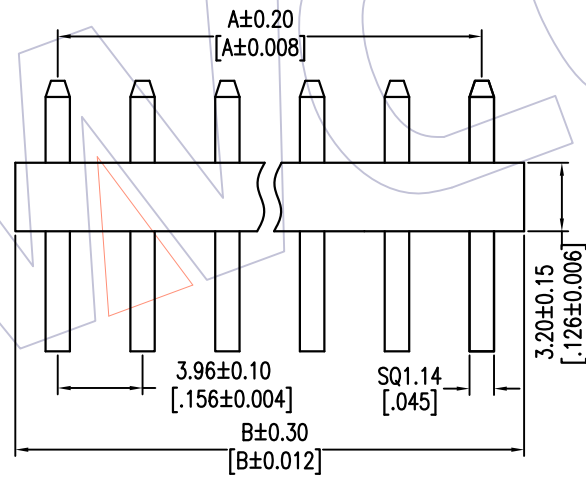

ITEM	A	D	B
Standard	3.80	4.50	9.30
Alternate			

REV	DATE	MODIFICATION DESCRIPTION	CHANGE	OPERATION	DRAW	DATE	SCALE	FIT	PART NO.
A2	2016/09/01	Modify	\triangle	x.x ±0.40	Surong Xu	2016/09/01	UNIT	mm	SEE TAB
A1	2015/05/13	Phosphor Bronze--Brass	\triangle	x.xx ±0.25	CHECK	DATE	SIZE	A4	TITLE: 3.96 WAFER 90°
AO	2012/09/15	NEW	---	x.xxx ±0.15	APPROVE	DATE	SHEET	1/1	Customer NO.
				Angle ± 3°			PROJ.	ϕ	
				DIM TOL					

WCON
Http: www.wcon.com

WCON-Dongguan
Tel: +86 769 85358920
Fax: +86 769 85358915
E-mail: sales@wcon.com

WCON-Kunshan
Tel: +86 512 57468408
Fax: +86 512 57468468
E-mail: salesks@wcon.com